

**RSA6100B Series Real-Time Signal Analyzers and  
RSA5100A Series Real-Time Signal Analyzers  
Option 53 Memory Extension, 4 GB Acquisition Memory Total  
Upgrade**

**Instructions**

[www.tektronix.com](http://www.tektronix.com)



071-2879-01

**Tektronix**

Copyright © Tektronix. All rights reserved. Licensed software products are owned by Tektronix or its subsidiaries or suppliers, and are protected by national copyright laws and international treaty provisions.

Tektronix products are covered by U.S. and foreign patents, issued and pending. Information in this publication supersedes that in all previously published material. Specifications and price change privileges reserved.

TEKTRONIX and TEK are registered trademarks of Tektronix, Inc.

## **Contacting Tektronix**

Tektronix, Inc.  
14150 SW Karl Braun Drive  
P.O. Box 500  
Beaverton, OR 97077  
USA

For product information, sales, service, and technical support:

- In North America, call 1-800-833-9200.
- Worldwide, visit [www.tektronix.com](http://www.tektronix.com) to find contacts in your area.

---

# Table of Contents

Service Safety Summary.....	1
Kit Description.....	2
Products.....	2
Kit Parts List .....	2
Installation Instructions .....	3
Minimum Tool and Equipment List .....	3
Remove Cosmetic Top Cover .....	3
Replace the Existing Acquisition Memory.....	5
Reinstall Cosmetic Top Cover.....	7
Option Key Installation .....	7



---

# Service Safety Summary

Only qualified personnel should perform service procedures. Read this *Service Safety Summary* and the *General Safety Summary* located in your instrument's Service manual ( the RSA6100B Service manual part number is 077-0648-XX and the RSA5100A Service manual part number is 077-0522-XX) before performing any service procedures.

**Do Not Service Alone.** Do not perform internal service or adjustments of this product unless another person capable of rendering first aid and resuscitation is present.

**Disconnect Power.** To avoid electric shock, switch off the instrument power, then disconnect the power cord from the mains power.

**Use Care When Servicing With Power On.** Dangerous voltages or currents may exist in this product. Disconnect power, remove battery (if applicable), and disconnect test leads before removing protective panels, soldering, or replacing components.

To avoid electric shock, do not touch exposed connections.

## Kit Description

This kit describes the installation of the Option 53 Memory Extension in an RSA6100B Series or RSA5100A Series Real-Time Signal Analyzer.

## Products

**RSA6100B Series. All instruments**

**RSA5100A Series. All instruments**

## Kit Parts List

Quantity	Part number	Description
1 ea	071-2879-01	RSA5UP OPTION 53 UPGRADE INSTRUCTIONS
1 ea	167-1473-XX	IC, MEMORY, DRAM; 512MX64, DDR2, 667MHZ, MT16HTS51264HY-667A1, SODIMM 200
1 ea	NS <sup>1</sup>	DATA SHEET; SOFTWARE OPTION KEY AUTHORIZATION CERTIFICATE, UPGRADE KITS
1 ea	NS <sup>1</sup>	LABEL, MANUFACTURED; OPTION KEY UPGRADE LABEL 2.100 X 2.700, SAFETY CONTROLLED

<sup>1</sup> NS – Not saleable

# Installation Instructions

This section contains all procedures needed to install Option 53 Memory Extension (4 GB Acquisition Memory Total) in RSA6100B Series and RSA5100A Series instruments.

## Minimum Tool and Equipment List

The following tools are required to install the Option 53 upgrade. All tools are standard tools that should be readily available.

**Table 1: Tools required for installation**

Item no.	Name	Description
1	Screwdriver handle (magnetic)	Torque driver handle. Accepts 1/4-in. hex-head driver tips
2	T15 TORX tip	TORX-driver tip for T15 size screws on the instrument covers
4	T20 TORX tip	TORX driver tip for T20 size screw heads

**Optional:** A torque wrench helps to ensure reliable connections to meet the nominal torque values that may be listed in these instructions.

These instructions are for qualified service personnel who are familiar with servicing the product. If you need further details for disassembling or reassembling the product, refer to the product service manual. Service manuals can be downloaded from the web at [www.tektronix.com/manuals](http://www.tektronix.com/manuals). Search by model number to find the service manual for your instrument.

## Remove Cosmetic Top Cover

**NOTE.** Right-side or left-side references in these instructions assume you are viewing the instrument from the front panel.



**WARNING.** To avoid electric shock which may result in injury or loss of life, switch off the instrument power, then disconnect the power cord from the mains power.

1. Remove the power cord.
2. If it is installed, pull the front protective cover off the instrument.

3. Remove the two T15 TORX-driver screws that secure the plastic carrying handle to the side of the instrument. (It is not necessary to remove the black metal handles.) (See Figure 1.)
4. Remove four T15 screws along each side that secure the top and bottom covers to the instrument, and remove two T20 screws near the front edge of the top cover (next to the folding handles).
5. Remove the top cover (leave the bottom cover in place). Remove the top cover by pulling straight back about 1 inch. Then pull the sides of the top cover outward, flexing them slightly to clear the instrument chassis, and pull it away from the instrument.
6. Remove the 18 T15 screws that secure the top internal cover to the chassis, and then remove the top internal cover from the instrument.

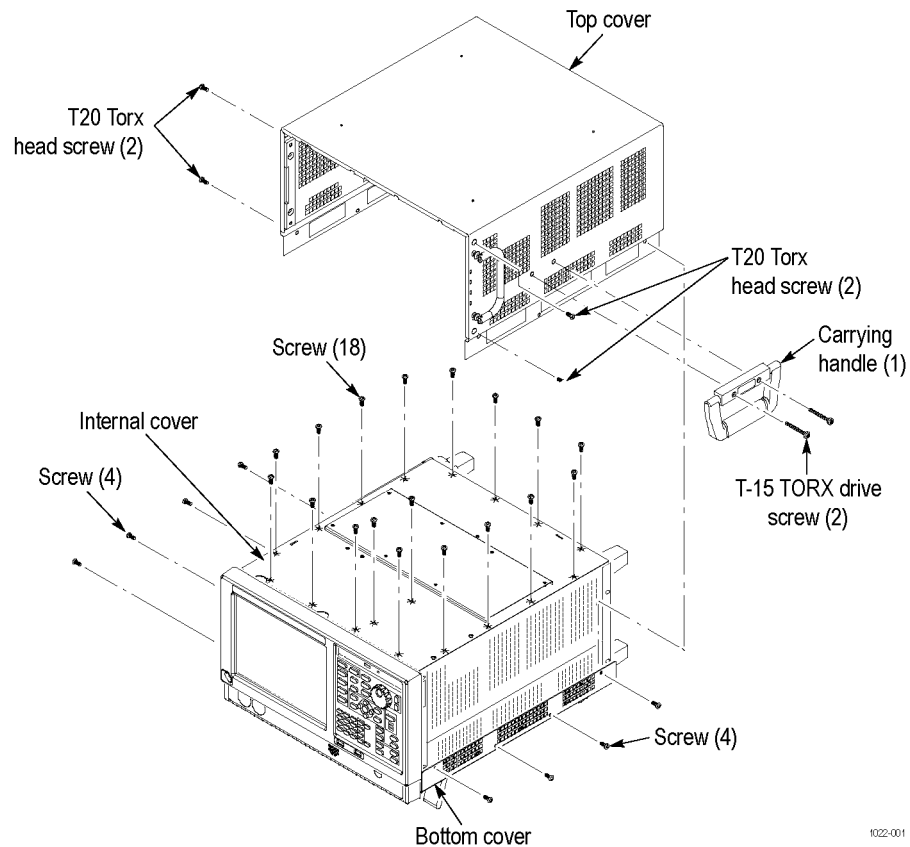
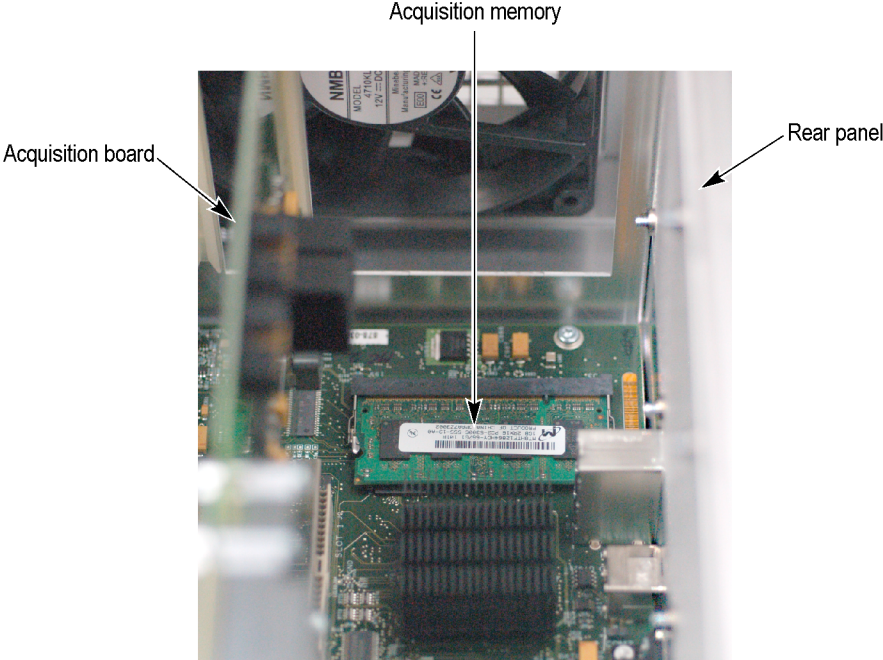

Figure 1: Removing the cosmetic top cover



# Replace the Existing Acquisition Memory

The acquisition memory is located near the rear panel, on the left side.



2879-001

1. Use the ejector latches to release the existing 1 GB acquisition memory module. Place the memory module into a static-shielded bag.



2. Insert the new memory module at an approximately 45° angle, making sure the gold “fingers” are fully seated. Then rotate the module down toward the board until the latches click into place.
3. Reinstall the top internal cover. (See Figure 1 on page 4.)
  - Place the top internal cover onto the instrument, aligning the two protrusions on the cover with the two slots in the chassis.
  - Replace the 18 T15 screws that secure the top internal cover to the chassis. Torque these screws to 8.0 in/lb.

## Reinstall Cosmetic Top Cover

Reinstall the top and bottom covers. (See Figure 1 on page 4.)

1. Place the instrument on the rear feet, so the front panel is facing up and the top is toward you.
2. Place the top cover over the top of the instrument and slide it toward the front panel. Make sure that the top cover wraps around the flanges on the rear panel on all three sides.
3. Reinstall the four T20 Torx head screws (two on each side) near the front edge of the top cover (next to the folding handles) that secure the top cover to the instrument. Torque these screws to 8.0 in/lb.
4. Align the four screw holes on each side in the top and bottom covers with the holes in the chassis, and install eight T15 screws, four on each side. Torque these screws to 8.0 in/lb.
5. Position the plastic carrying handle and its bracket on the right side of the instrument, and install the two T15 screws that secure it in place. Torque these screws to 8.0 in/lb.

## Option Key Installation

To enter the new option key:

1. In the signal analyzer application, select **Tools > Install Upgrades**. The Install Upgrade wizard starts. (See Figure 2.) Click **Continue**.

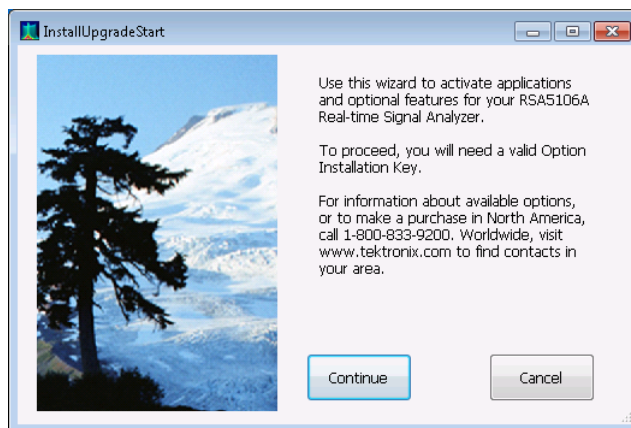
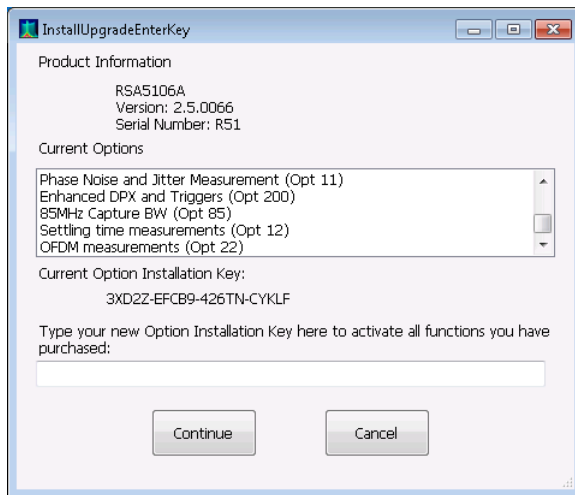

Figure 2: Starting the option upgrade

2. The **Install Upgrade Enter Key** screen appears as shown.



**Figure 3: Entering the option installation key**

3. Type the option installation key into the empty text box and click **Continue**. An **Installation Success** dialog box appears after you click Continue.
4. Click **Close**. Exit and restart the RSA application to enable the new feature.
5. Select **Help > About Tektronix Real Time Signal Analyzer**.
6. In the installed Options window, verify that Option 53 is listed.
7. Click **OK**.

### Installing the Option Key Label

Place the new option key label over the existing label on the instrument rear panel.

This completes the installation of the Option 53 Memory Extension, 4 GB Acquisition Memory Total Upgrade kit.

■ **End of Document** ■